

REV.	ECN.	DATE	DWN	APVD

MATERIAL:

INSULATOR : PPS (UL 94V-0)
 CONTACT : PIN(OUTE SLEEVE) : COPPER ALLOY
 CLIP(CONTACT 4 FINGER) : BERYLLIUM COPPER
 PLATING(OUTER SLEEVE) : TIN PLATED
 PLATING(CONTACT) : FULL GOLD

SPECIFICATION:

CURRENT RATING : 3A
 DIELECTRIC WITHSTANDING VOLTAGE : 500V AC FOR 1 MINUTE
 INSULATION RESISTANCE : 1000MΩ MIN
 CONTACT RESISTANCE : 4mΩ MAX.
 OPERATING TEMPERATURE : -55°C ~ +105°C.

Order Information :

SIB 1 2 - 0 6 2 1 1 D 0 0 0 - R
 1 2 3 4 5 6 7 8 9 10

1. SERIES NUMBER	SIB12 : 2.54mm PITCH I.C. SOCKET MACHINED PIN DIP TYPE		
2. POSITION	01 TO 40		
3. CONTACT TYPE	2 : FEMALE (CLIP : BERYLLIUM, PIN : COPPER ALLOY)		
4. CONTACT PLATING	CODE	CLIP PLATED	PIN PLATED
	1	GOLD FLASH	TIN 200u"
5. INSULATOR COLOR	1 : BLACK		
6. INSULATOR MATERIAL	D : PPS		
7. SPACING	0 : SINGLE ROW		
8. OPTIONS	0 : STANDARD TYPE		
9. PIN LENGTH	0 : 7.43mm		
10. GREEN PRODUCT	BLANK : NOT GREEN PRODUCT R : RoHS		

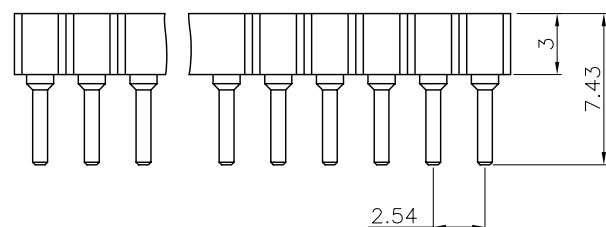
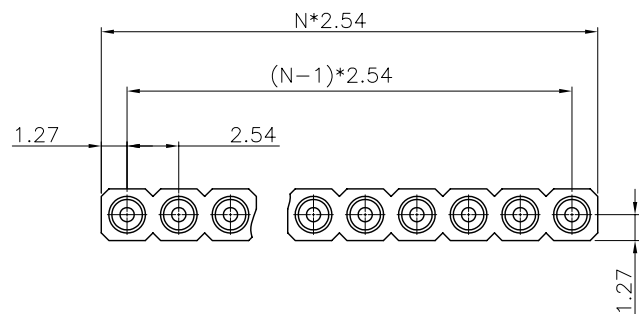

WEKANG CO., LTD.
 維鼎股份有限公司
 TEL:886-2-26436301 FAX:886-2-26432714

SIZE A4	UNIT mm	SCALE 2 / 1	SHEET 1 OF 1	
------------	------------	----------------	-----------------	--

GENERAL TOLERANCE
 X.X ± 0.3
 X.XX ± 0.15

ANGLE TOLERANCE ± 1°
 RADIUS ± 0.25
 HOLE ± 0.13

DRAWN.	JEAN	DATE	10 - 24 - 2005
CHECKED.	HENRY	DATE	11 - 02 - 2005
APPROVED.	HENRY	DATE	11 - 02 - 2005

DRAWING NO.	SIB12-XX211D000-R	C13016
TITLE.	2.54mm PITCH I.C. SOCKET MACHINED PIN DIP TYPE, SINGLE ROW	
PART NO.	SIB12-XX211D000-R	REV A.0

REV.	ECN.	DATE	DWN	APVD

MATERIAL:

INSULATOR : PPS (UL 94V-0)
 CONTACT : PIN(OUTE SLEEVE) : COPPER ALLOY
 CLIP(CONTACT 4 FINGER) : BERYLLIUM COPPER
 PLATING(OUTER SLEEVE) : TIN PLATED
 PLATING(CONTACT) : FULL GOLD

SPECIFICATION:

CURRENT RATING : 3A
 DIELECTRIC WITHSTANDING VOLTAGE : 500V AC FOR 1 MINUTE
 INSULATION RESISTANCE : 1000MΩ MIN
 CONTACT RESISTANCE : 4mΩ MAX.
 OPERATING TEMPERATURE : -55°C ~ +105°C.

Order Information :

SIB 1 2 - 0 6 2 1 1 D 1 0 0 - R
 1 2 3 4 5 6 7 8 9 10

1. SERIES NUMBER	SIB12 : 2.54mm PITCH I.C. SOCKET MACHINED PIN DIP TYPE		
2. POSITION	02 TO 80		
3. CONTACT TYPE	2 : FEMALE (CLIP : BERYLLIUM, PIN : COPPER ALLOY)		
4. CONTACT PLATING	CODE	CLIP PLATED	PIN PLATED
	1	GOLD FLASH	TIN 200u"
5. INSULATOR COLOR	1 : BLACK		
6. INSULATOR MATERIAL	D : PPS		
7. SPACING	1 : DAUL ROWS		
8. OPTIONS	0 : STANDARD TYPE		
9. PIN LENGTH	0 : 7.43mm		
10. GREEN PRODUCT	BLANK : NOT GREEN PRODUCT R : RoHS		

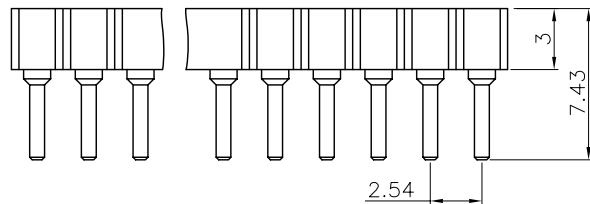
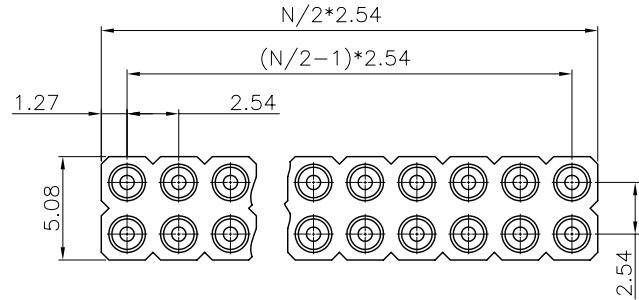

維鼎股份有限公司
 WEKANG CO., LTD.
 TEL:886-2-26436301 FAX:886-2-26432714

GENERAL TOLERANCE
 X.X ±0.3
 X.XX ±0.15

ANGLE TOLERANCE ± 1°
 RADIUS ± 0.25
 HOLE ± 0.13

DRAWN.	JEAN	DATE	10 - 24 - 2005
CHECKED.	HENRY	DATE	11 - 02 - 2005
APPROVED.	HENRY	DATE	11 - 02 - 2005

DRAWING NO.	SIB12-XX211D100-R	C13016
TITLE.	2.54mm PITCH I.C. SOCKET MACHINED PIN DIP TYPE, DUAL ROWS	
PART NO.	SIB12-XX211D100-R	REV A.0

SIZE A4	UNIT mm	SCALE. 2 / 1	SHEET. 1 OF 1	
------------	------------	-----------------	------------------	--

REV.	ECN.	DATE	DWN	APVD

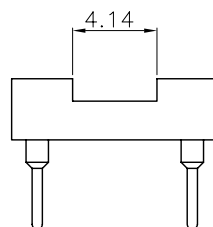
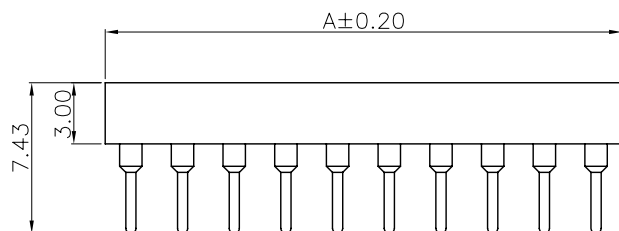
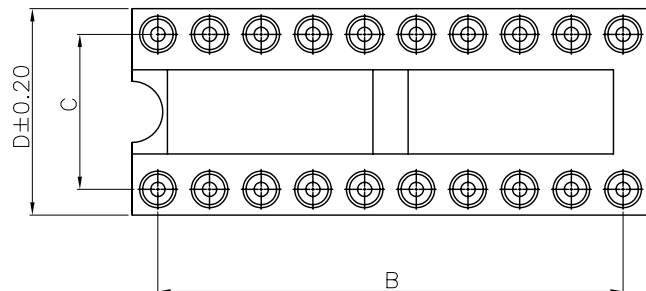

MATERIAL:

INSULATOR : PBT + GLASS FIBER (UL 94V-0)
 CONTACT : PIN(OUTER SLEEVE) : COPPER ALLOY
 CLIP(CONTACT 4 FINGER) : BERYLLIUM COPPER
 PLATING(OUTER SLEEVE) : TIN PLATED 200u"
 PLATING(CONTACT) : FULL GOLD

SPECIFICATION:

CURRENT RATING : 3A
 DIELECTRIC WITHSTANDING VOLTAGE : 500V AC FOR 1 MINUTE
 INSULATION RESISTANCE : 1000MΩ MIN
 CONTACT RESISTANCE : 4mΩ MAX.
 OPERATING TEMPERATURE : -55°C ~ +105°C.

Order Information :

SIB 1 2 - 2 0 2 1 1 B 3 0 0 - R
 1 2 3 4 5 6 7 8 9 10

1. SERIES NUMBER	SIB12 : 2.54mm PITCH I.C. SOCKET MACHINED PIN DIP TYPE		
2. POSITION	06 08 14 16 18 20 22 24 28 32 40 42 48 50 52 64		
3. CONTACT TYPE	2 : FEMALE (CLIP : BERYLLIUM, PIN : COPPER ALLOY)		
4. CONTACT PLATING	CODE	CLIP PLATED	PIN PLATED
	1	GOLD FLASH	TN 200u"
5. INSULATOR COLOR	1 : BLACK		
6. INSULATOR MATERIAL	B : PBT		
7. SPACING	3 : 7.62mm/0.3" 4 : 10.16mm/0.4" 6 : 15.24mm/0.6" 9 : 22.86mm/0.9"		
8. OPTIONS	0 : W/O BAR(OPEN FRAME) 1 : WITH BAR(OPEN FRAME W/BAR)		
9. PIN LENGTH	0 : 7.43mm		
10. GREEN PRODUCT	BLANK : NOT GREEN PRODUCT R : RoHS		

POSITION	A	B	C	D	POSITION	A	B	C	D
6P	7.62	5.08	7.62	10.16	32P	40.64	38.10	10.16	12.70
8P	10.16	7.62			24P	30.48	27.94	15.24	17.78
14P	17.78	15.24			28P	35.56	33.02		
16P	20.32	17.78			32P	40.64	38.10		
18P	22.86	20.32			40P	50.80	48.26		
20P	25.40	22.86			42P	53.34	50.80		
24P	30.48	27.94	10.16	12.70	48P	60.96	58.24		
28P	35.56	33.02			50P	63.50	60.96		
20P	25.40	22.86			52P	66.04	63.50		
22P	27.94	25.40			50P	63.50	60.96		
24P	30.48	27.94			52P	66.04	63.50		
28P	35.56	33.02			64P	81.28	78.74		



維鼎股份有限公司
 WEKANG CO., LTD.
 TEL:886-2-26436301 FAX:886-2-26432714

GENERAL TOLERANCE
 X.X ±0.3
 X.XX ±0.15

ANGLE TOLERANCE ± 1°
 RADIUS ± 0.25
 HOLE ± 0.13

DRAWN. JEAN
 CHECKED. HENRY
 APPROVED. HENRY

DATE 10 - 24 - 2005
 DATE 11 - 02 - 2005
 DATE 11 - 02 - 2005

DRAWING NO. SIB12-XX211BXX0-R C13016
 TITLE. 2.54mm PITCH I.C. SOCKET MACHINED PIN DIP TYPE
 PART NO. SIB12-XX211BXX0-R REV A.0

SIZE A4 UNIT mm SCALE. 2 / 1 SHEET. 1 OF 1

