

REV.	ECN.	DATE	DWN	APVD
A.1	ECN-060628-01	06/06/28	TRACY	HENRY
A.2	ECN-070201-01	07/02/09	TRACY	HENRY

POSITION	DIM A	DIM B	DIM C
4	11.68	7.82	2.54
6	14.22	10.36	5.08
8	16.76	12.90	7.62
10	19.31	15.44	11.16
12	21.84	17.98	12.71
14	24.38	20.52	15.24
16	26.92	23.06	17.78
18	29.46	25.61	20.32
20	32.00	28.14	22.86
22	34.54	31.68	25.40
24	37.18	33.22	27.94
26	39.62	35.76	31.48
28	42.16	38.30	33.02
30	44.70	40.84	35.56
32	47.24	43.38	38.10
34	49.78	45.92	40.64
36	52.32	48.46	43.18
38	54.86	51.11	45.72
40	57.41	53.54	48.26
44	62.48	58.62	53.34
48	67.56	63.70	58.42
50	70.10	66.24	60.96
60	82.80	78.94	73.66
62	85.34	81.48	76.20
64	87.88	84.12	78.74
70	95.50	91.64	86.36
72	98.04	94.18	88.90
80	108.20	104.34	99.06
86	115.82	111.96	106.68
98	138.68	134.82	129.54
100	133.60	129.74	124.46
108	143.76	139.90	134.62
120	159.00	155.14	149.86

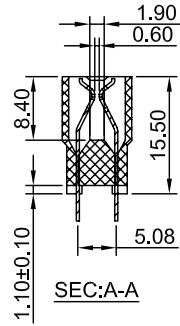
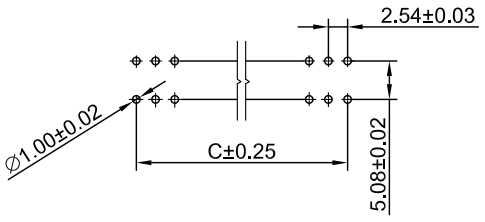
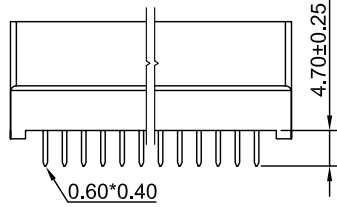
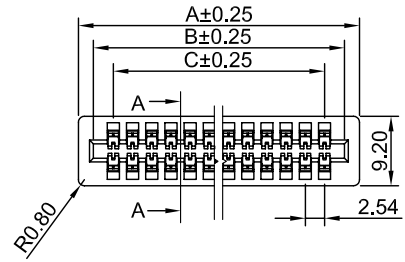

MATERIAL:

INSULATOR : CLASS-FILLED P.B.T. UL 94V-0
CONTACT : PHOSPHOR BRONZE
CONTACT FINISH : GOLD ON MATING END, TIN ON TERMINATION END, WITH ENTIRE CONTACT NICKEL UNDERPLATED.

SPECIFICATION:

CURRENT RATING : 3A
DIELECTRIC WITHSTANDING VOLTAGE : 800V AC/1MIN.
INSULATION RESISTANCE : 5000MΩ MIN.
CONTACT RESISTANCE : 20mΩ MAX.
OPERATING TEMPERATURE : -55°C ~ +105°C.

ORDER INFORMATION :

ECB11 - 036 2 1 1 B 0 0 - R
1 2 3 4 5 6 7

- SERIES NUMBER:
- POSITION:
004~120
- CONTACT TYPE:
2 = PHOSPHOR BRONZE
- CONTACT PLATING:
1 = SELEVTIVE GOLD FLASH
- INSULATOR COLOR:
1 = BLACK
- INSULATOR MATERIAL:
B = PBT
- GREEN PRODUCT:
R=RoHS COMPLIANT

WEKANG CO., LTD.
<http://www.wekang.com>

SIZE A4 UNIT mm SCALE. 1 : 1 SHEET. 1 OF 1

GENERAL TOLERANCE

X.X	± 0.38
X.XX	± 0.25
RADIUS	± 0.20
HOLE	± 0.10
ANGLE	± 1°

DRAWN.	TRACY	DATE	06 - 02 - 2006
CHECKED.	HENRY	DATE	06 - 05 - 2006
APPROVED.	HENRY	DATE	06 - 05 - 2006

DRAWING NO.	C-EC0001
TITLE.	2.54mm PITCH, EDGE CARD CONN STRAIGHT TYPE, W/O MOUNTING EARS
PART NO.	ECB11-XXX211B00-R

CUSTOMER DRAWING	
REV	A.2