

REV.	ECN.	DATE	DWN	APVD

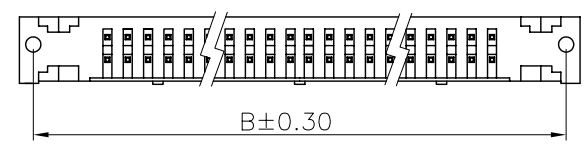

POSITION	A	B	C
10	32.00	27.94	10.16
14	37.08	33.02	15.24
16	39.62	35.56	17.78
20	44.70	40.64	22.86
24	49.78	45.72	27.94
26	52.32	48.26	30.48
30	57.40	53.34	35.56
34	62.48	58.42	40.64
40	70.10	66.04	48.26
50	82.80	78.74	60.96
60	95.50	91.44	73.66
64	100.58	96.52	78.74

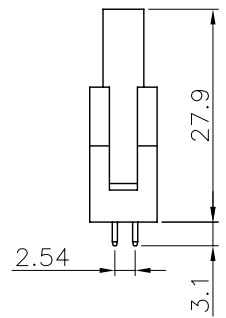
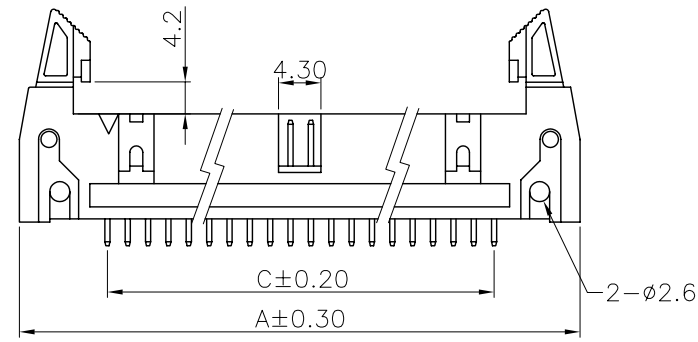
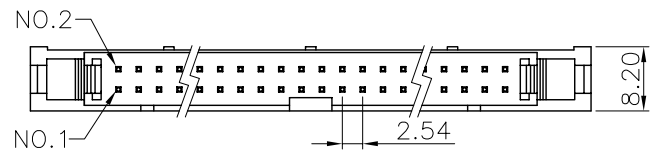
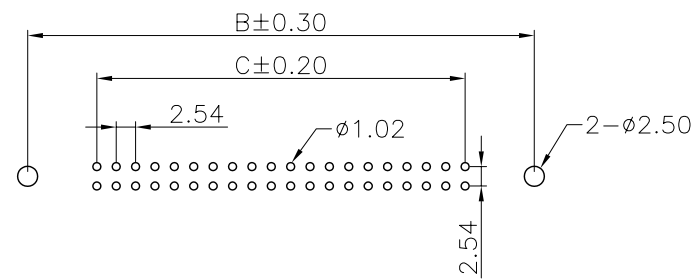

P.C.B. LAYOUT
TOP VIEW

MATERIAL:

INSULATOR : THERMOPLASTIC, (UL 94V-0)
CONTACT : COPPER ALLOY
CONTACT FINISH : GOLD OVER NICKEL

SPECIFICATION:

CURRENT RATING : 3A
DIELECTRIC WITHSTANDING VOLTAGE : 1000V AC FOR 1 MINUTE
INSULATION RESISTANCE : 1000MΩ MIN.
CONTACT RESISTANCE : 20mΩ MAX.
OPERATING TEMPERATURE : -55°C ~ +105°C.

Order Information :

HLB11 - 2 0 1 A 1 B 0 0 - R
1 2 3 4 5 6 7 8 9

1. SERIES NUMBER	HLB11 : 2.54mm PITCH FULLY LATCH HEADER STRAIGHT DIP TYPE
2. POSITION	10 14 16 20 22 24 26 30 34 40 44 50 60 64
3. CONTACT MATERIAL	1 : COPPER ALLOY
4. CONTACT PLATING	1 : SELECTIVE GOLD FLASH 4 : SELECTIVE GOLD 15u" 6 : SELECTIVE GOLD 30u" A : FULL GOLD FLASH T : TIN
5. INSULATOR COLOR	1 : BLACK 8 : GRAY
6. INSULATOR MATERIAL	B : PBT
7. OPTION	0 : W/ SHORT LATCH
8. SPECIAL OPTION	0 : STANDARD TYPE
9. GREEN PRODUCT	BLANK : NOT GREEN PRODUCT R : RoHS

WEKANG CO., LTD.
TEL:886-2-26436301 FAX:886-2-26432714

SIZE A4 UNIT mm SCALE 1/1 SHEET 1 OF 1

GENERAL TOLERANCE
X.X ±0.30
X.XX ±0.20
X.XXX ±0.10
ANGLE TOLERANCE ±1°
RADIUS ±0.25
HOLE ±0.13

DRAWN. JEAN
CHECKED. HENRY
APPROVED. HENRY

DATE 12 - 09 - 2005
DATE 12 - 14 - 2005
DATE 12 - 14 - 2005

DRAWING NO. HLB11-XX1XXX00-R C09011
TITLE. 2.54mm PITCH FULLY LATCH HEADER STRAIGHT DIP TYPE
PART NO. HLB11-XX1XXX00-R REV A.0

REV.	ECN.	DATE	DWN	APVD

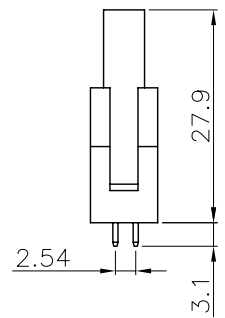
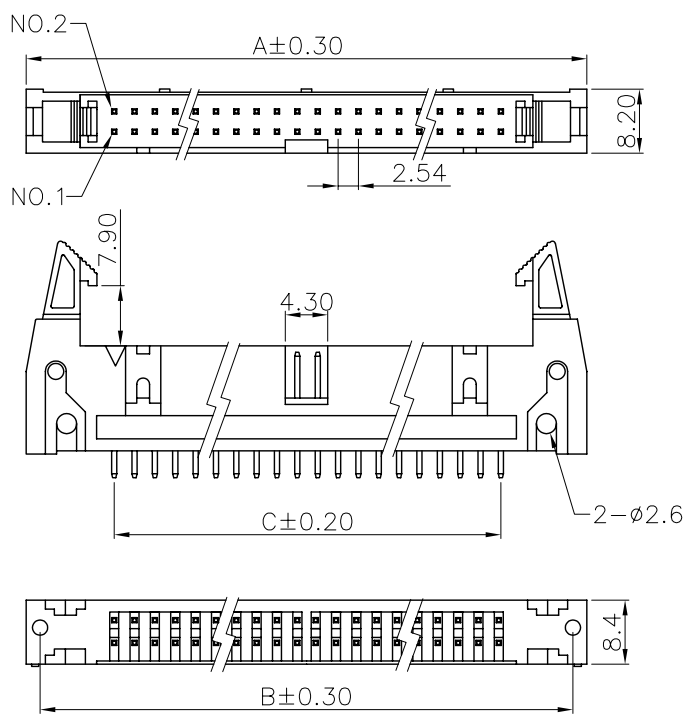

MATERIAL:

INSULATOR : THERMOPLASTIC, (UL 94V-0)
 CONTACT : COPPER ALLOY
 CONTACT FINISH : GOLD OVER NICKEL

SPECIFICATION:

CURRENT RATING : 3A
 DIELECTRIC WITHSTANDING VOLTAGE : 1000V AC FOR 1 MINUTE
 INSULATION RESISTANCE : 1000MΩ MIN.
 CONTACT RESISTANCE : 20mΩ MAX.
 OPERATING TEMPERATURE : -55°C ~ +105°C.

Order Information :

HLB11 - 4 0 1 A 1 B 1 0 - R
 1 2 3 4 5 6 7 8 9

POSITION	A	B	C
10	32.00	27.94	10.16
14	37.08	33.02	15.24
16	39.62	35.56	17.78
20	44.70	40.64	22.86
24	49.78	45.72	27.94
26	52.32	48.26	30.48
30	57.40	53.34	35.56
34	62.48	58.42	40.64
40	70.10	66.04	48.26
50	82.80	78.74	60.96
60	95.50	91.44	73.66
64	100.58	96.52	78.74

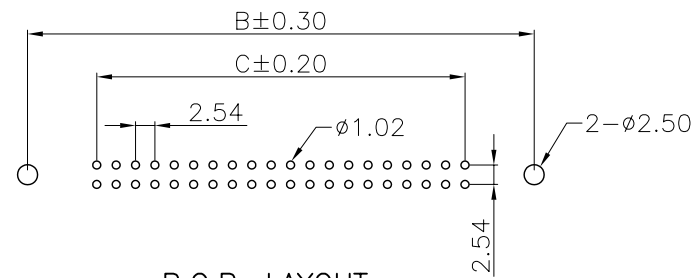

P.C.B. LAYOUT
TOP VIEW

1. SERIES NUMBER	HLB11 : 2.54mm PITCH FULLY LATCH HEADER STRAIGHT DIP TYPE
2. POSITION	10 14 16 20 22 24 26 30 34 40 44 50 60 64
3. CONTACT MATERIAL	1 : COPPER ALLOY
4. CONTACT PLATING	1 : SELECTIVE GOLD FLASH 4 : SELECTIVE GOLD 15u" 6 : SELECTIVE GOLD 30u" A : FULL GOLD FLASH T : TIN
5. INSULATOR COLOR	1 : BLACK 8 : GRAY
6. INSULATOR MATERIAL	B : PBT
7. OPTION	1 : W/ LONG LATCH
8. SPECIAL OPTION	0 : STANDARD TYPE
9. GREEN PRODUCT	BLANK : NOT GREEN PRODUCT R : RoHS

WEKANG CO., LTD.
 維鼎股份有限公司
 TEL:886-2-26436301 FAX:886-2-26432714

SIZE A4 UNIT mm SCALE 1/1 SHEET 1 OF 1

GENERAL TOLERANCE
 X.X ±0.30
 X.XX ±0.20
 X.XXX ±0.10
 ANGLE TOLERANCE ±1°
 RADIUS ±0.25
 HOLE ±0.13

DRAWN. JEAN
 CHECKED. HENRY
 APPROVED. HENRY

DATE 12 - 09 - 2005
 DATE 12 - 14 - 2005
 DATE 12 - 14 - 2005

DRAWING NO. HLB11-XX1XXX10-R C09011
 TITLE. 2.54mm PITCH FULLY LATCH HEADER STRAIGHT DIP TYPE
 PART NO. HLB11-XX1XXX10-R REV A.0

REV.	ECN.	DATE	DWN	APVD

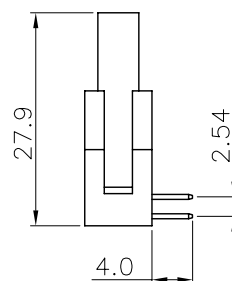
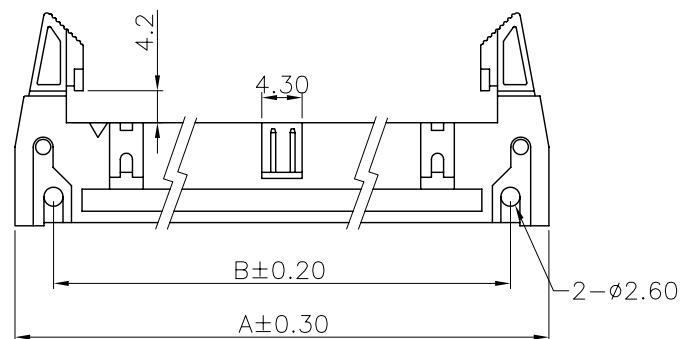
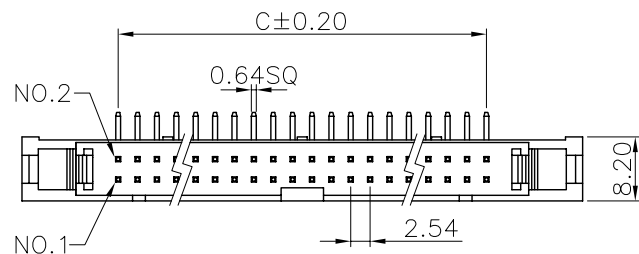

POSITION	A	B	C
10	32.00	21.84	10.16
14	37.08	26.92	15.24
16	39.62	29.46	17.78
20	44.70	34.54	22.86
24	49.78	39.62	27.94
26	52.32	42.16	30.48
30	57.40	47.24	35.56
34	62.48	52.32	40.64
40	70.10	59.94	48.26
50	82.80	72.64	60.96
60	95.50	85.34	73.66
64	100.58	90.42	78.74

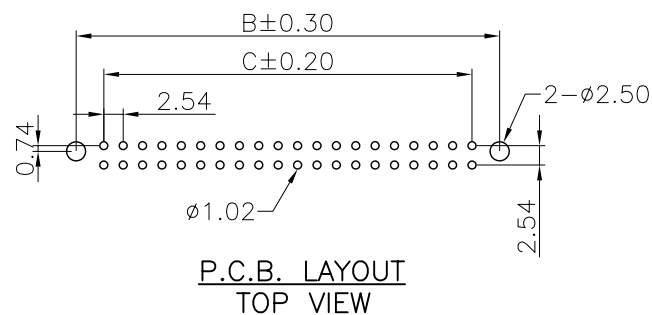

MATERIAL:

INSULATOR : THERMOPLASTIC, (UL 94V-0)
 CONTACT : COPPER ALLOY
 CONTACT FINISH : GOLD OVER NICKEL

SPECIFICATION:

CURRENT RATING : 3A
 DIELECTRIC WITHSTANDING VOLTAGE : 1000V AC FOR 1 MINUTE
 INSULATION RESISTANCE : 1000MΩ MIN.
 CONTACT RESISTANCE : 20mΩ MAX.
 OPERATING TEMPERATURE : -55°C ~ +105°C.

Order Information :

HLB91 - 4 0 1 A 1 B 0 0 - R
 1 2 3 4 5 6 7 8 9

1. SERIES NUMBER	HLB91 : 2.54mm PITCH FULLY LATCH HEADER RIGHT ANGLE DIP TYPE
2. POSITION	10 14 16 20 22 24 26 30 34 40 44 50 60 64
3. CONTACT MATERIAL	1 : COPPER ALLOY
4. CONTACT PLATING	1 : SELECTIVE GOLD FLASH 4 : SELECTIVE GOLD 15u" 6 : SELECTIVE GOLD 30u" A : FULL GOLD FLASH T : TIN
5. INSULATOR COLOR	1 : BLACK 8 : GRAY
6. INSULATOR MATERIAL	B : PBT
7. OPTION	0 : W/ SHORT LATCH
8. SPECIAL OPTION	0 : STANDARD TYPE
9. GREEN PRODUCT	BLANK : NOT GREEN PRODUCT R : RoHS

WEKANG CO., LTD.
 維鼎股份有限公司
 TEL:886-2-26436301 FAX:886-2-26432714

SIZE A4	UNIT mm	SCALE 1/1	SHEET 1 OF 1
---------	---------	-----------	--------------

GENERAL TOLERANCE
 X.X ±0.30
 X.XX ±0.20
 X.XXX ±0.10
 ANGLE TOLERANCE ±1°
 RADIUS ±0.25
 HOLE ±0.13

DRAWN.	JEAN	DATE	12 - 09 - 2005
CHECKED.	HENRY	DATE	12 - 14 - 2005
APPROVED.	HENRY	DATE	12 - 14 - 2005

DRAWING NO.	HLB91-XX1XXX00-R	C09011
TITLE.	2.54mm PITCH FULLY LATCH HEADER RIGHT ANGLE DIP TYPE	
PART NO.	HLB91-XX1XXX00-R	REV A.0

REV.	ECN.	DATE	DWN	APVD

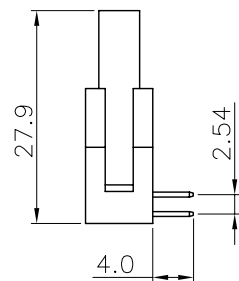
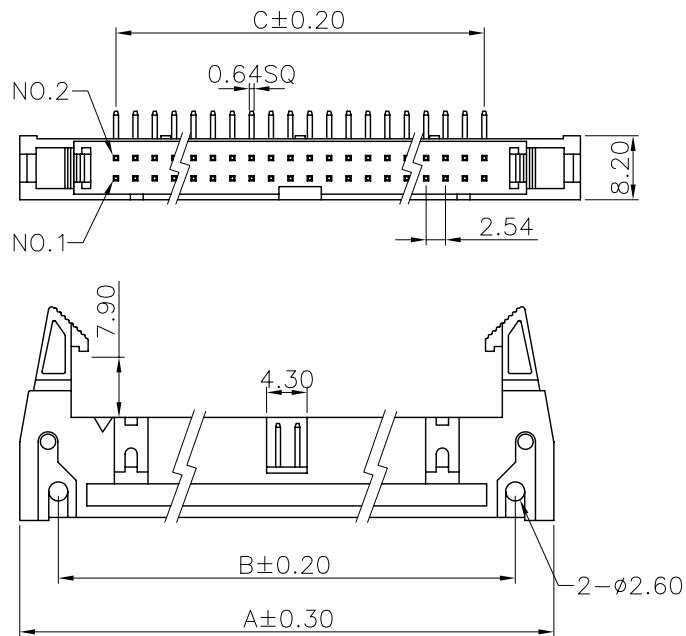

POSITION	A	B	C
10	32.00	21.84	10.16
14	37.08	26.92	15.24
16	39.62	29.46	17.78
20	44.70	34.54	22.86
24	49.78	39.62	27.94
26	52.32	42.16	30.48
30	57.40	47.24	35.56
34	62.48	52.32	40.64
40	70.10	59.94	48.26
50	82.80	72.64	60.96
60	95.50	85.34	73.66
64	100.58	90.42	78.74

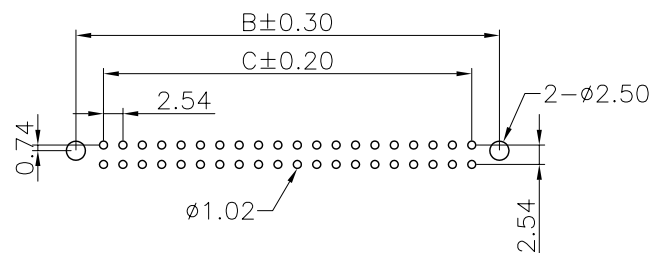

P.C.B. LAYOUT
TOP VIEW

MATERIAL:

INSULATOR : THERMOPLASTIC, (UL 94V-0)
CONTACT : COPPER ALLOY
CONTACT FINISH : GOLD OVER NICKEL

SPECIFICATION:

CURRENT RATING : 3A
DIELECTRIC WITHSTANDING VOLTAGE : 1000V AC FOR 1 MINUTE
INSULATION RESISTANCE : 1000MΩ MIN.
CONTACT RESISTANCE : 20mΩ MAX.
OPERATING TEMPERATURE : -55°C ~ +105°C.

Order Information :

HLB91 - 4 0 1 A 1 B 1 0 - R
1 2 3 4 5 6 7 8 9

1. SERIES NUMBER	HLB91 : 2.54mm PITCH FULLY LATCH HEADER RIGHT ANGLE DIP TYPE
2. POSITION	10 14 16 20 22 24 26 30 34 40 44 50 60 64
3. CONTACT MATERIAL	1 : COPPER ALLOY
4. CONTACT PLATING	1 : SELECTIVE GOLD FLASH 4 : SELECTIVE GOLD 15u" 6 : SELECTIVE GOLD 30u" A : FULL GOLD FLASH T : TIN
5. INSULATOR COLOR	1 : BLACK 8 : GRAY
6. INSULATOR MATERIAL	B : PBT
7. OPTION	1 : W/ LONG LATCH
8. SPECIAL OPTION	0 : STANDARD TYPE
9. GREEN PRODUCT	BLANK : NOT GREEN PRODUCT R : RoHS



維鼎股份有限公司
WEKANG CO., LTD.
TEL:886-2-26436301 FAX:886-2-26432714

GENERAL TOLERANCE
X.X ±0.30
X.XX ±0.20
X.XXX ±0.10
ANGLE TOLERANCE ±1°
RADIUS ±0.25
HOLE ±0.13

DRAWN. JEAN
CHECKED. HENRY
APPROVED. HENRY

DATE 12 - 09 - 2005
DATE 12 - 14 - 2005
DATE 12 - 14 - 2005

DRAWING NO. HLB91-XX1XXX10-R C09011
TITLE. 2.54mm PITCH FULLY LATCH HEADER
RIGHT ANGLE DIP TYPE
PART NO. HLB91-XX1XXX10-R REV A.0

SIZE A4 UNIT mm SCALE 1/1 SHEET 1 OF 1