

REV.	ECN.	DATE	DWN	APVD

MATERIAL:

INSULATOR : PBT, (UL 94V-0)
 CONTACT : COPPER ALLOY, t=0.4mm
 CONTACT FINISH : GOLD OVER NICKEL

SPECIFICATION:

CURRENT RATING : 3AMP
 DIELECTRIC WITHSTANDING VOLTAGE : 1000V AC PER MINUTE
 INSULATION RESISTANCE : 1000MΩ MIN.
 CONTACT RESISTANCE : 30mΩ MAX.
 OPERATING TEMPERATURE : -55°C ~ +105°C.

Order Information :

SHB11 1 - 2 0 0 A B 0 0 - R
 1 2 3 4 5 6 7 8

1. SERIES NUMBER	SHB11 : 2.54mm PITCH FEMALE HEADER STRAIGHT TYPE PROFILE : 8.5mm
2. ROW TYPE	1 : SINGLE ROW
3. POSITION PER ROW	02 ~ 40
4. CONTACT MATERIAL	0 : COPPER ALLOY
5. CONTACT PLATING	1 : SELECTIVE GOLD FLASH 4 : SELECTIVE GOLD 15u" 6 : SELECTIVE GOLD 30u" A : FULL GOLD FLASH T : TIN
6. INSULATOR MATERIAL	B : PBT C : NYLON
7. SPECIAL OPTION	00 : STANDARD TYPE
8. GREEN PRODUCT	R : RoHS

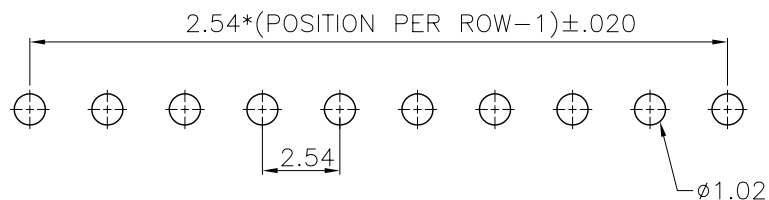
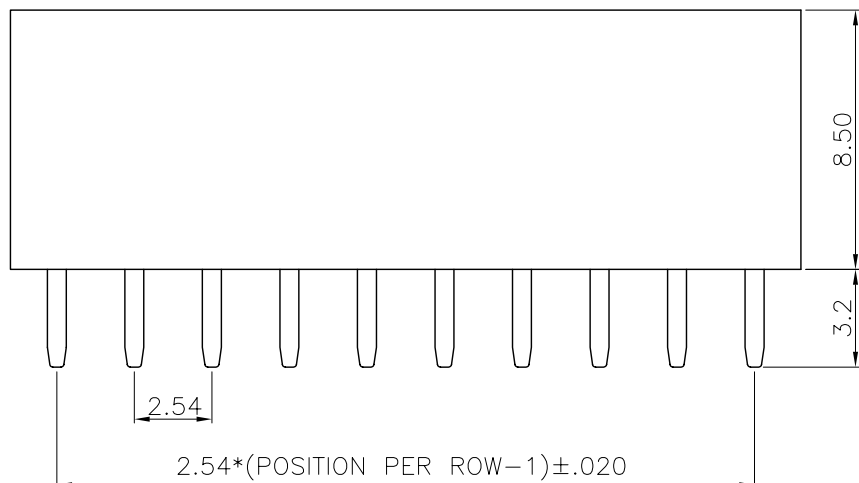
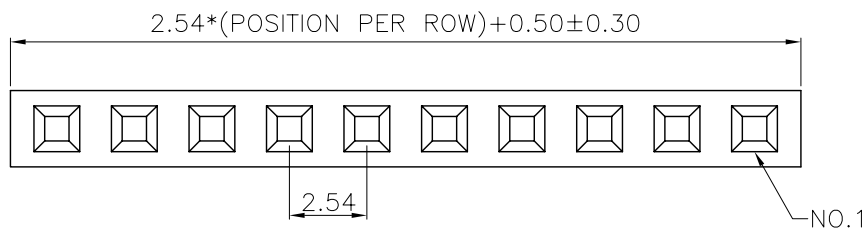

PCB LAYOUT



維鼎股份有限公司
 WEKANG CO., LTD.
 TEL:886-2-26436301 FAX:886-2-26432714

GENERAL TOLERANCE
 X.X ±0.30
 X.XX ±0.20
 X.XXX ±0.10
 ANGLE TOLERANCE ±1°
 RADIUS ±0.25
 HOLE ±0.13

DRAWN. JEAN
 CHECKED. HENRY
 APPROVED. HENRY

DATE 12 - 20 - 2005
 DATE 12 - 21 - 2005
 DATE 12 - 21 - 2005

DRAWING NO. SHB111-XX0XX00-R C09011
 TITLE. 2.54mm PITCH FEMALE HEADER
 STRAIGHT TYPE SINGLE ROW PROFILE : 8.5mm
 PART NO. SHB111-XX0XX00-R REV A.0

SIZE A4	UNIT mm	SCALE 4 / 1	SHEET 1 OF 1	
---------	---------	-------------	--------------	--

REV.	ECN.	DATE	DWN	APVD

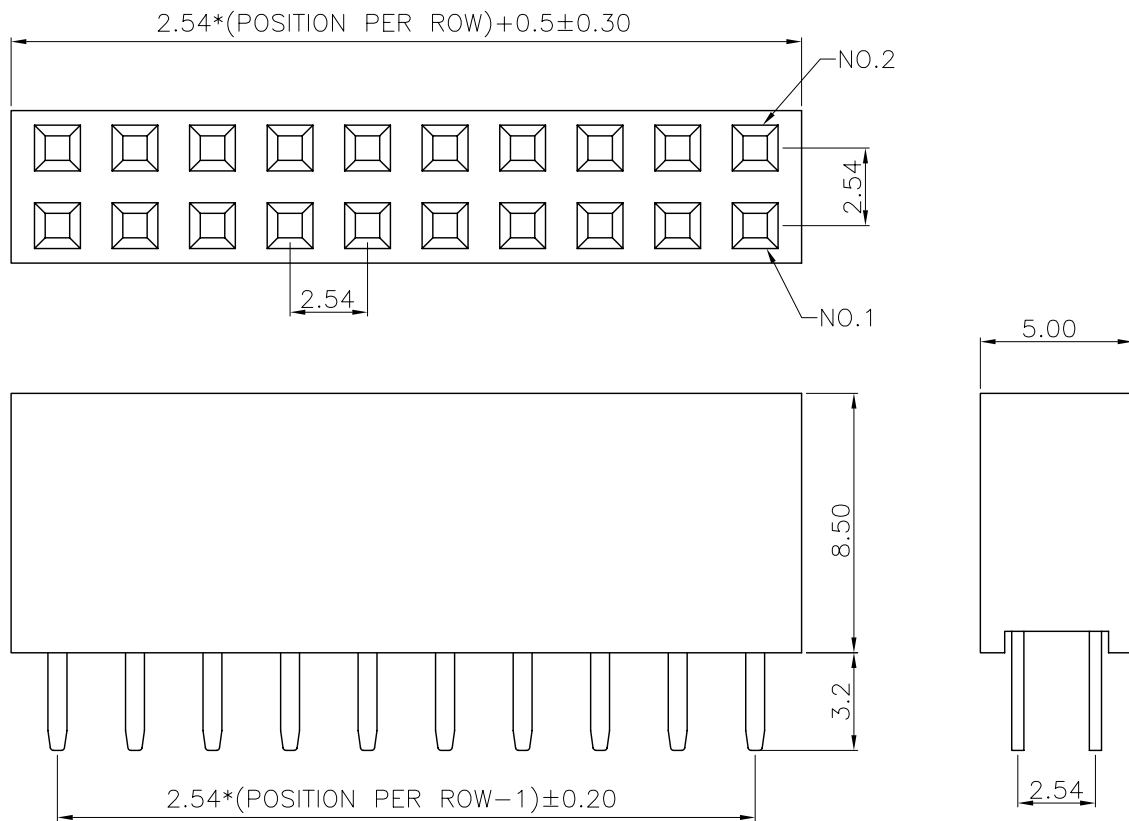

MATERIAL:

INSULATOR : PBT,(UL 94V-0)
 CONTACT : COPPER ALLOY, t=0.4mm
 CONTACT FINISH : GOLD OVER NICKEL

SPECIFICATION:

CURRENT RATING : 3AMP
 DIELECTRIC WITHSTANDING VOLTAGE : 1000V AC PER MINUTE
 INSULATION RESISTANCE : 1000MΩ MIN.
 CONTACT RESISTANCE : 30mΩ MAX.
 OPERATING TEMPERATURE : -55°C ~ +105°C.

Order Information :

SHB11 2 - 20 0 A B 00 - R
 1 2 3 4 5 6 7 8

1. SERIES NUMBER	SHB11 : 2.54mm PITCH FEMALE HEADER STRAIGHT TYPE PROFILE : 8.5mm
2. ROW TYPE	2 : DUAL ROWS
3. POSITION PER ROW	02 ~ 40
4. CONTACT MATERIAL	0 : COPPER ALLOY
5. CONTACT PLATING	1 : SELECTIVE GOLD FLASH 4 : SELECTIVE GOLD 15u" 6 : SELECTIVE GOLD 30u" A : FULL GOLD FLASH
6. INSULATOR MATERIAL	B : PBT C : NYLON
7. SPECIAL OPTION	00 : STANDARD TYPE
8. GREEN PRODUCT	R : RoHS

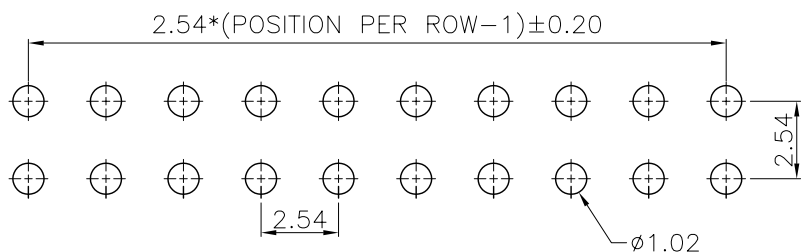

PCB LAYOUT

WEKANG 維鼎股份有限公司
 WEKANG CO., LTD.
 TEL:886-2-26436301 FAX:886-2-26432714

SIZE A4	UNIT mm	SCALE 4/1	SHEET 1 OF 1
---------	---------	-----------	--------------

GENERAL TOLERANCE
 X.X ±0.30
 X.XX ±0.20
 X.XXX ±0.10
 ANGLE TOLERANCE ±1°
 RADIUS ±0.25
 HOLE ±0.13

DRAWN.	JEAN	DATE	12 - 20 - 2005
CHECKED.	HENRY	DATE	12 - 21 - 2005
APPROVED.	HENRY	DATE	12 - 21 - 2005

DRAWING NO.	SHB112-XX0XX00-R	C09011
TITLE.	2.54mm PITCH FEMALE HEADER STRAIGHT TYPE DUAL ROWS PROFILE : 8.5mm	
PART NO.	SHB112-XX0XX00-R	REV A.0

REV.	ECN.	DATE	DWN	APVD

MATERIAL:

INSULATOR : PBT, (UL 94V-0)
 CONTACT : COPPER ALLOY, t=0.4mm
 CONTACT FINISH : GOLD OVER NICKEL

SPECIFICATION:

CURRENT RATING : 3AMP
 DIELECTRIC WITHSTANDING VOLTAGE : 1000V AC PER MINUTE
 INSULATION RESISTANCE : 1000MΩ MIN.
 CONTACT RESISTANCE : 30mΩ MAX.
 OPERATING TEMPERATURE : -55°C ~ +105°C.

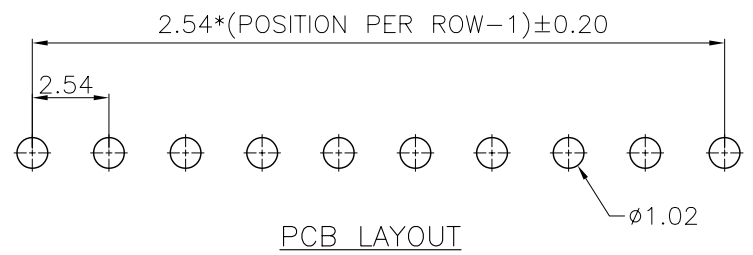
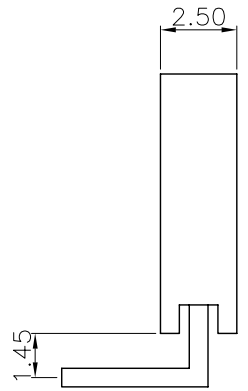
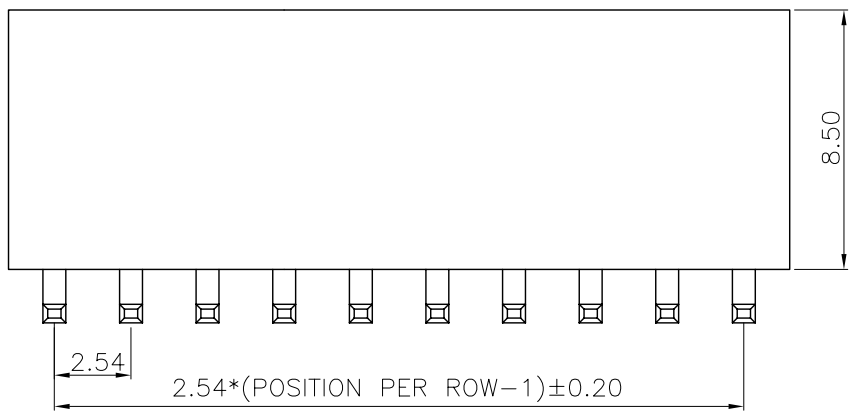
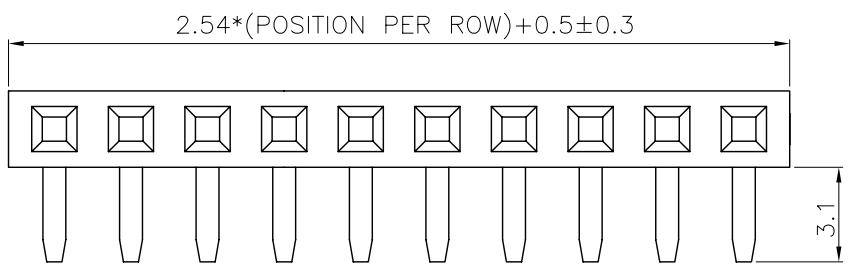

Order Information :

SHB91 1 - 10 0 A B 00 - R
 1 2 3 4 5 6 7 8

1. SERIES NUMBER	SHB91 : 2.54mm PITCH FEMALE HEADER RIGHT ANGLE TYPE PROFILE : 8.5mm
2. ROW TYPE	1 : SINGLE ROW
3. POSITION PER ROW	02 ~ 40
4. CONTACT MATERIAL	0 : COPPER ALLOY
5. CONTACT PLATING	1 : SELECTIVE GOLD FLASH 4 : SELECTIVE GOLD 15u" 6 : SELECTIVE GOLD 30u" A : FULL GOLD FLASH T : TIN
6. INSULATOR MATERIAL	B : PBT C : NYLON
7. SPECIAL OPTION	00 : STANDARD TYPE
9. GREEN PRODUCT	R : RoHS

WEKANG CO., LTD.
 維鼎股份有限公司
 TEL:886-2-26436301 FAX:886-2-26432714

SIZE A4	UNIT mm	SCALE 4 / 1	SHEET 1 OF 1	
------------	------------	----------------	-----------------	--

GENERAL TOLERANCE
 X.X ±0.30
 X.XX ±0.20
 X.XXX ±0.10
 ANGLE TOLERANCE ± 1°
 RADIUS ±0.25
 HOLE ±0.13

DRAWN.	JEAN	DATE	12 - 20 - 2005
CHECKED.	HENRY	DATE	12 - 21 - 2005
APPROVED.	HENRY	DATE	12 - 21 - 2005

DRAWING NO.	SHB911-XX0XX00-R	C09011
TITLE.	2.54mm PITCH FEMALE HEADER RIGHT ANGLE TYPE SINGLE ROW PROFILE : 8.5mm	
PART NO.	SHB911-XX0XX00-R	REV A.0

REV.	ECN.	DATE	DWN	APVD
A.1	ECN-080128-01	03/11/08	TRACY	HENRY

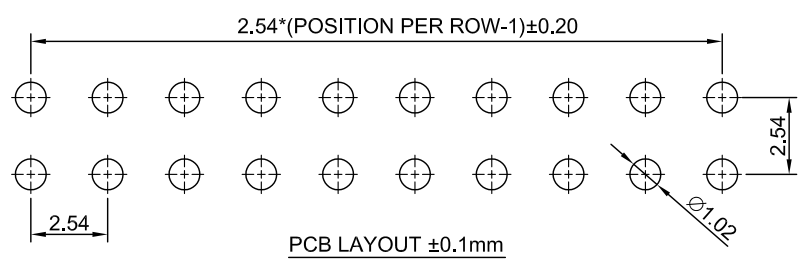
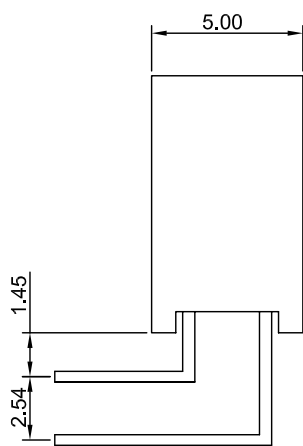
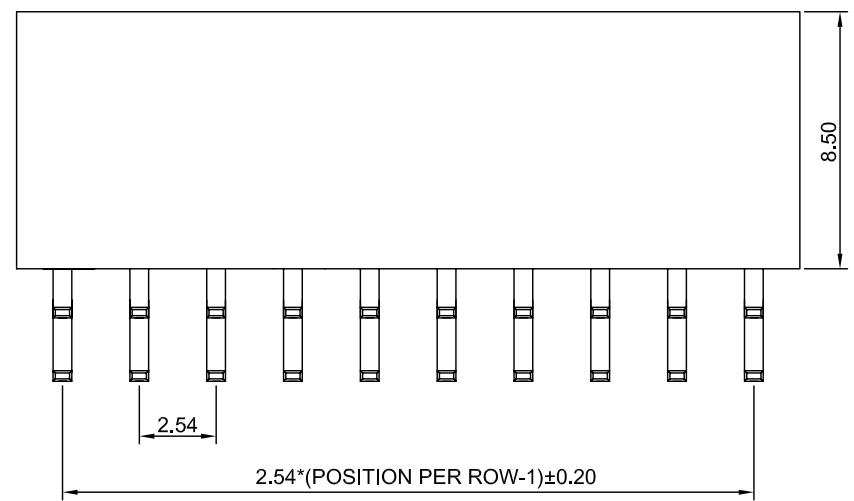
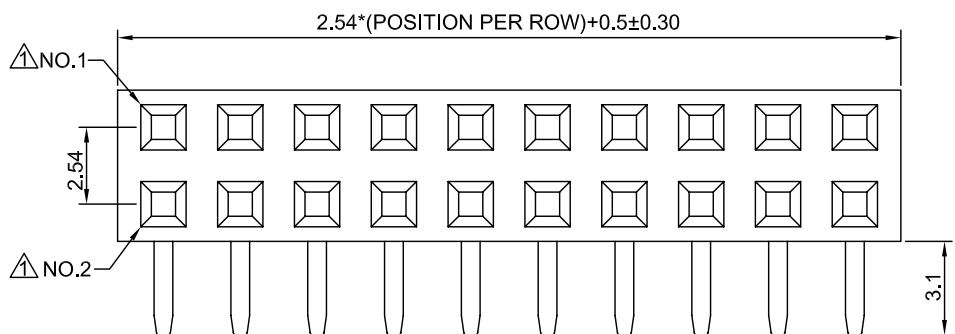

MATERIAL:

INSULATOR : THERMOPLASTIC ,UL 94V-0.
 STANDARD : PBT.
 CONTACT : COPPER ALLOY, T=0.4mm.
 CONTACT FINISH : GOLD OVER NICKEL.

SPECIFICATION:

CURRENT RATING : 3 AMP.
 DIELECTRIC WITHSTANDING VOLTAGE : 1000V AC FOR 1 MINUTE.
 INSULATION RESISTANCE : 1000MΩ MIN. AT 500V DC.
 CONTACT RESISTANCE : 30mΩ MAX.
 OPERATING TEMPERATURE : -55°C ~ +105°C.

ORDER INFORMATION :

S H B 9 1 2 - 2 0 0 A B 0 0 - R
 1 2 3 4 5 6 7 8

- | | |
|---|--|
| 1. SERIES: | 6. INSULATOR MATERIAL: |
| 2. ROW TYPE:
2=DUAL ROWS | B=PBT
C=NYLON |
| 3. POSITION PER ROW:
02~40 | 7. SPECIAL OPTION:
00=STANDARD TYPE |
| 4. CONTACT TYPE/MATERIAL:
0=FEMALE/COPPER ALLOY | 9. GREEN PRODUCT:
R=RoHS COMPLIANT |
| 5. CONTACT PLATING:
1=SELECTIVE GOLD FLASH
4=SELECTIVE 15u" GOLD
6=SELECTIVE 30u" GOLD
A=FULL GOLD FLASH
T=TIN | |

 **WEKANG CO., LTD.**
<http://www.wekang.com>

SIZE A4	UNIT mm	SCALE. 4 : 1	SHEET. 1 OF 1
------------	------------	-----------------	------------------

GENERAL TOLERANCE X.X ± 0.30 X.XX ± 0.20 X.XXX ± 0.10 ANGLE TOLERANCE ± 1° RADIUS ± 0.25 HOLE ± 0.13	DRAWN. JEAN CHECKED. HENRY APPROVED. HENRY	DATE 12 - 20 - 2005 DATE 12 - 21 - 2005 DATE 12 - 21 - 2005	DRAWING NO. C-SH0018 TITLE. 2.54mm PITCH FEMALE HEADER RIGHT ANGLE TYPE DUAL ROWS PROFILE : 8.5mm	CUSTOMER DRAWING
	PART NO. SHB912-XX0XX00-R			REV A.1